

**This electronic collection of documents is provided
for the convenience of the user
and is Not a Certified Document –**

**The documents contained herein were originally issued
and sealed by the individuals whose names and license
numbers appear on each page, on the dates appearing
with their signature on that page.**

**This file or an individual page
shall not be considered a certified document.**

TIP PROJECT: N/A

CONTRACT: DN00713

JACKSON COUNTY

PROJECT REFERENCE NO.		SHEET NO.
2020CPT1.14.09.10501		
STATE PROJECT	F.A. PROJECT NO.	DESCRIPTION
		DN00713

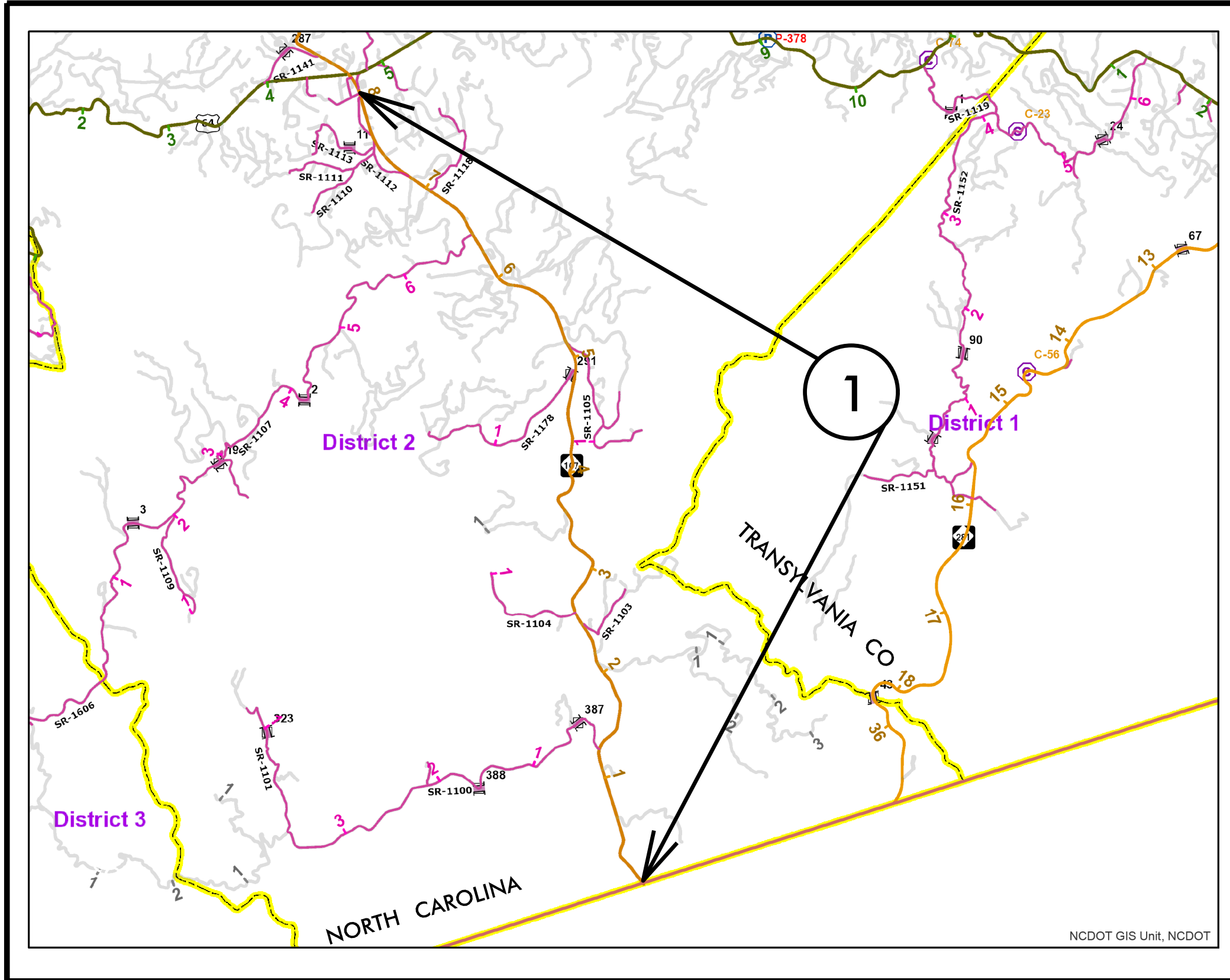

MAP 1



BEG



END

PROJECT REFERENCE NO.		SHEET NO.
2020CPT 14.09.10501		2
STATE PROJECT	F.A. PROJECT NO.	DESCRIPTION
		DN00713

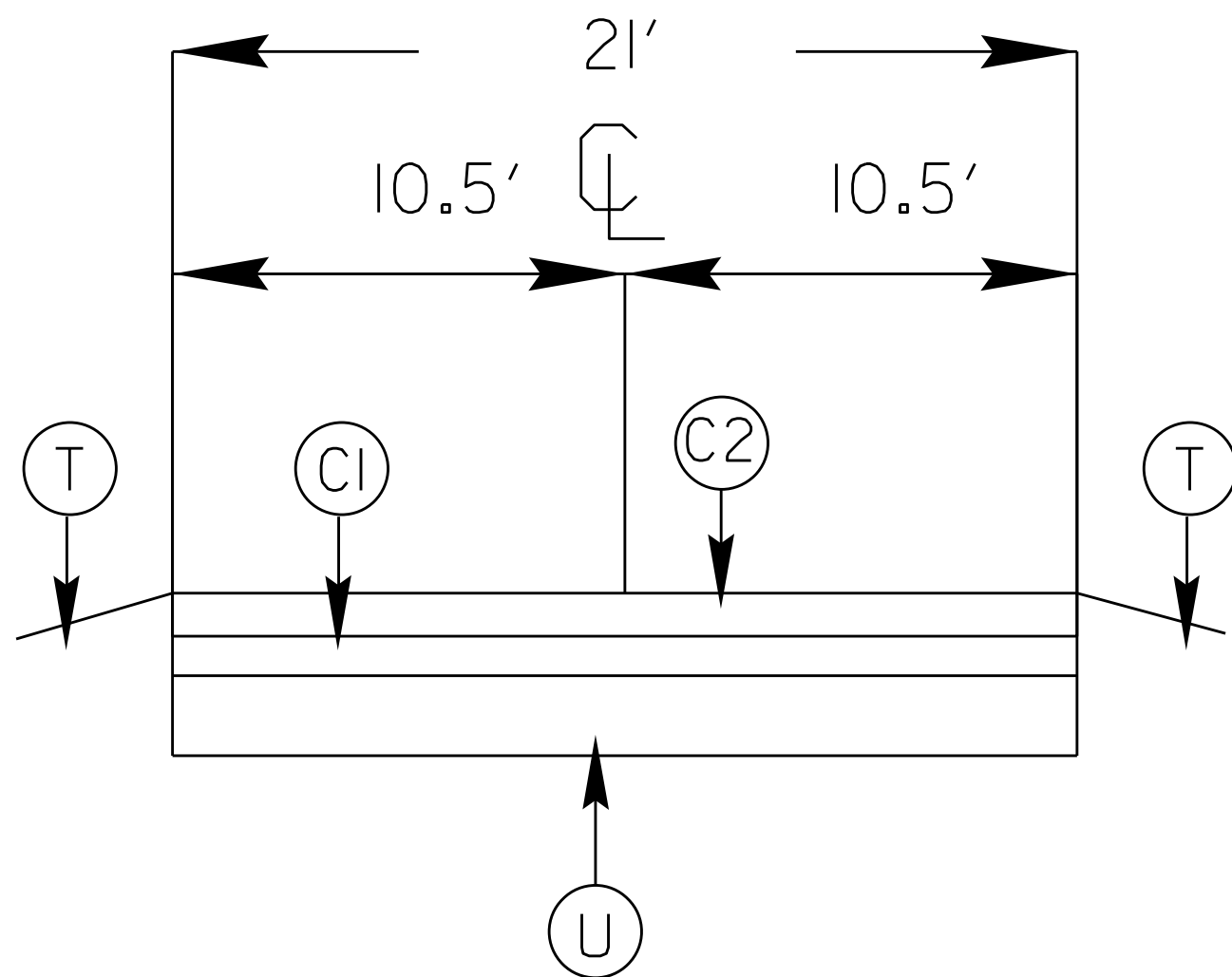

SURFACING SCHEDULE

ITEM NO	DESCRIPTION
C1	PROP. APPROX. 1" ASPHALT CONCRETE SURFACE COURSE, (LEVELING) TYPE S9.5B, AT AN AVERAGE RATE OF 110 LBS PER SQ. YD. AT LOCATIONS AS DIRECTED BY PROJECT ENGINEER
C2	PROP. APPROX. 1 1/4" ASPHALT CONCRETE SURFACE COURSE, TYPE S9.5B AT AN AVERAGE RATE OF 137.5 LBS.PER.SQ.YD
T	SHOULDER RECONSTRUCTION
U	EXISTING ASPHALT

PROJECT NO.	SHEET NO.	TOTAL NO.
2020CPT.14.09.10501	3	3

SUMMARY OF QUANTITIES

PROJECT NO	COUNTY	MAP NO	ROUTE	DESCRIPTION	TYP NO	LANES	LANE TYPE	FINAL SURFACE TESTING REQUIRED	WARM MIX ASPHALT REQUIRED	LENGTH	WIDTH	1245000000-E	1519000000-E	1520000000-E	1575000000-E	1704000000-E	2830000000-N		
												SHOULDER RECONSTRUCTION	SURFACE COURSE, S9.5B	LEVELING COURSE, S9.5B	ASPHALT BINDER FOR PLANT MIX	PATCHING EXISTING PAVEMENT	ADJ. OF MANHOLES		
												MI	FT	SMI	TONS	TONS	TONS	TONS	EA
2020CPT.14.09.10501	Jackson	1	NC 107	FROM .01 MILES SOUTH OF US 64 TO SC LINE	1	2	2WU	NO	NO	8.21	21	16.42	7,775	5,561	894	861	5		
TOTAL FOR MAP NO. 1												8.21		16.42	7,775	5,561	894	861	5
TOTAL FOR PROJ NO. 2020CPT.14.09.10501												8.21		16.42	7,775	5,561	894	861	5
GRAND TOTAL												8.21		16.42	7,775	5,561	894	861	5

THERMOPLASTIC AND PAINT QUANTITIES

PROJECT NO	COUNTY	MAP NO	ROUTE	DESCRIPTION	TYP NO	LANES	LANE TYPE	LENGTH	WIDTH	13000000	67000000	4695000000-E	4710000000-E	4721000000-E	4810000000-E		4890000000-E		4892000000-N		
										WORK ZONE ADVANCE/GENERAL WARNING SIGNING	TEMPORARY TRAFFIC CONTROL	8" X 90 M WHITE THERMO	24" X 120 M WHITE THERMO	THERMO MSG SCHOOL 120 M	4" YELLOW PAINT	4" WHITE PAINT	GENERIC PAVE. MARK ITEM 4" X 60 MIL YELLOW THERMO.	GENERIC PAVE. MARK ITEM 4" X 60 MIL WHITE THERMO	GENERIC PAVE. MARK ITEM. NON-METALIC HOUSING SNOWPLOWABLE MARKERS		
										MI	FT	SF	LS	LF	LF	EA	LF	LF	EA		
2020CPT.14.09.10501	Jackson	1	NC 107	FROM .01 MILES SOUTH OF US 64 TO SC LINE	1	2	2WU	8.21	21	561	1.00	84	400	12	87,697	87,697	87,697	87,697	561		
TOTAL FOR MAP NO. 1										8.21		561	1	84	400	12	87,697	87,697	87,697	87,697	561
TOTAL FOR PROJ NO. 2020CPT.14.09.10501										8.21		561	1	84	400	12	87,697	87,697	87,697	87,697	561
GRAND TOTAL										8.21		561	1	84	400	12	87,697	87,697	87,697	87,697	561

SIGNING FOR RESURFACING PROJECTS

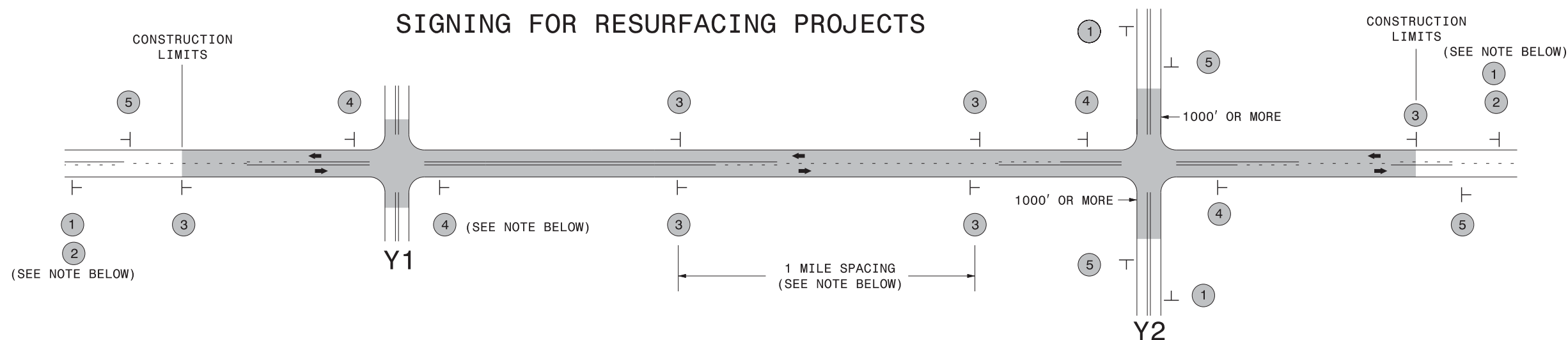

LEGEND	
┆	STATIONARY SIGN
←	DIRECTION OF TRAFFIC FLOW

MAINLINE (-L-) SIGNING

-Y- LINE SIGNING

SIGNING NOTES AND PLACEMENT PER DIRECTION	MAINLINE (-L-) SIGNING		-Y- LINE SIGNING	
	1	 W20-1 48" X 48"	PLACE 1000' PRIOR TO BEGINNING OF CONSTRUCTION LIMITS. ONLY USED ON -Y- LINES IF RESURFACING LIMITS EXTEND 1000' ALONG -Y- LINE.	<p>NO REQUIRED STATIONARY SIGNING FOR THE FOLLOWING -Y- LINE CONDITIONS:</p> <ol style="list-style-type: none"> 1) LESS THAN 1000' OF RESURFACING ALONG -Y- LINE 2) SUBDIVISION ROADS 3) DEAD END ROADS <p>WHEN PAVING/CONSTRUCTION ACTIVITIES PROCEED ACROSS AN UNSIGNED -Y- LINE, ADVANCE WARNING PORTABLE SIGNS SHALL BE USED ALONG THE -Y- LINE AS SHOWN BELOW. REMOVE UPON COMPLETION OF WORK.</p> <div style="display: flex; justify-content: space-around;"> <div style="text-align: center;"> W20-1 48" X 48" </div> <div style="text-align: center;"> W20-7 A 48" X 48" </div> </div> <p>PLACED 500' IN ADVANCE OF FLAGGER. PLACED 250' IN ADVANCE OF FLAGGER.</p>
	2	 W7-3aP 24" X 18"	#2 SIGN ONLY USED WHEN RESURFACING LIMITS ARE 2 OR MORE MILES IN LENGTH. ROUND UP TO NEXT WHOLE NUMBER. (NO FRACTIONAL OR DECIMAL NUMBERS)	
	3	 SP 13107 48" X 48"	PLACE INITIALLY AT THE CONSTRUCTION LIMITS AND SPACED 1 MILE APART THEREAFTER. IF NO -Y- LINES EXIST, PLACE 2ND SET 1/2 MILE FROM THE CONSTRUCTION LIMITS AND THEN SPACE 1 MILE THEREAFTER.	
	4	 SP 13106 48" X 48"	THESE ARE FOR -Y- LINES THAT ARE "THROUGH" ROADWAYS. DEAD END AND SUBDIVISION ROADS ARE NOT "THROUGH" ROADWAYS. INSTALL 500' +/- FROM EACH -Y- LINE APPROACH AS SHOWN ABOVE. FOR MULTIPLE -Y- LINES THAT ARE SEPARATED BY 0.25 MILES OR LESS, TREAT AS A SINGLE UNIT AND INSTALL WITHIN 500' OF EACH APPROACH. A MAXIMUM OF 2 SIGN SETS PER MILE. DO NOT INSTALL WHEN -Y- LINES ARE WITHIN 0.5 MILES FROM "END ROAD WORK" SIGN.	
5	 G20-2 A 48" X 24"	PLACE 500' FOLLOWING THE END OF CONSTRUCTION LIMITS.		

3/19/2015
 C:\Users\rmgarrett\Downloads\Resurfacing_AdvWarn_2Ln (2).dgn
 User:rmgarrett

**RESURFACING
ADVANCE WARNING SIGNS
FOR
RURAL AND SUBURBAN
2 LANE ROADWAYS**